

Location Map with Latitude and Longitude for the Project named **110, RAYNAGAR** situated at Premises No. 110, Raynagar, Borough - XI, Ward No. - 112 of KMC, PS – Bansdroni, Kolkata - 700070, WB, India:

LATITUDE	LONGITUDE
22°-27'-51"N	88°-22'-26"E

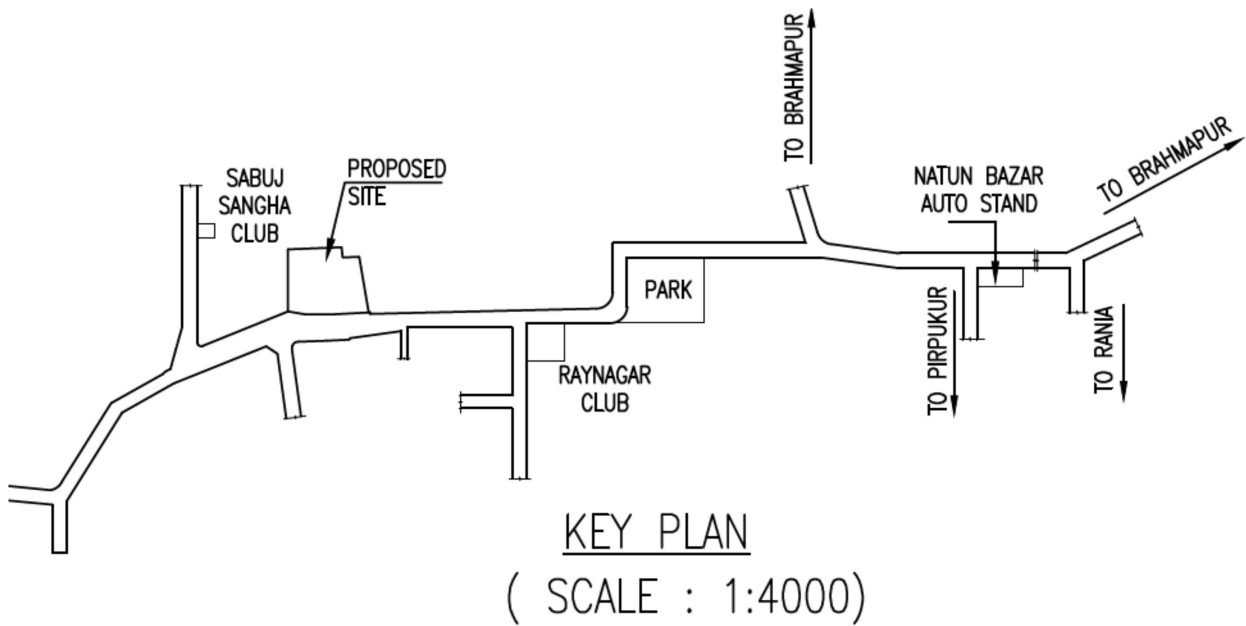
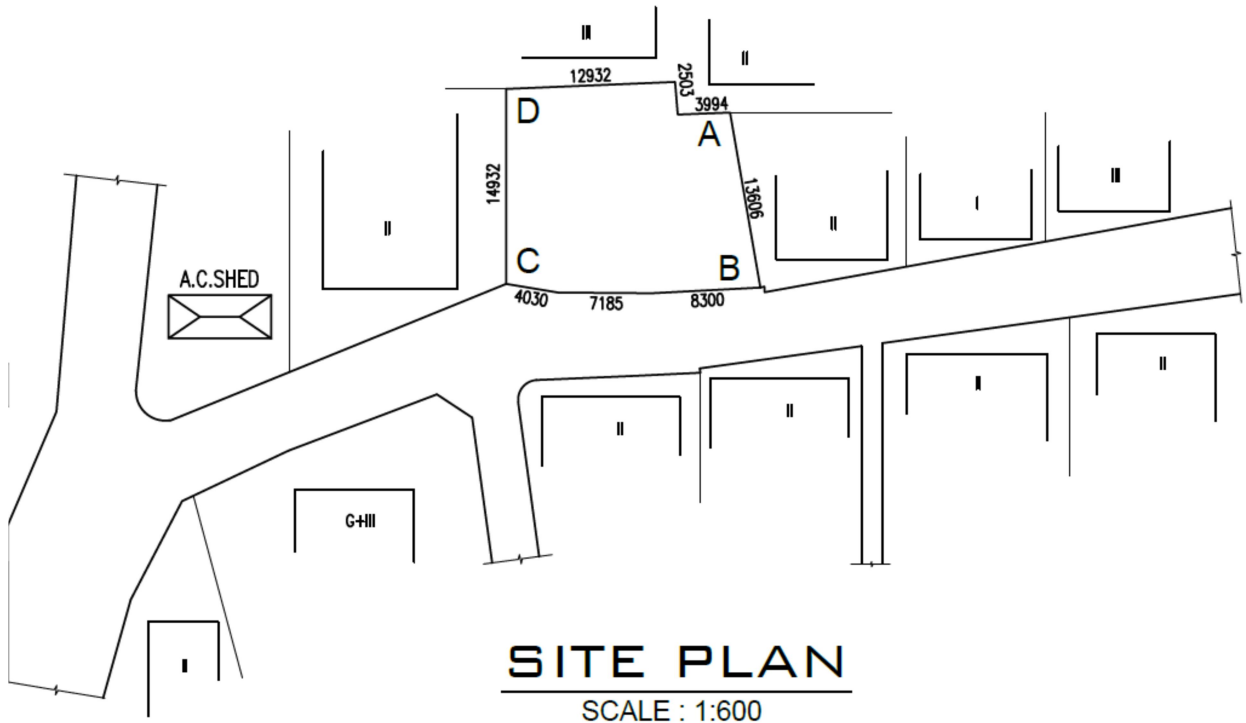

**MAA CONSTRUCTION**  
*Tapas Naskar*  
Proprietor